

PARKING & SF COUNTS	
<b>BUILDING 1</b> MEDICAL OFFICE BUILDING 5,400 SF	REQUIRED PARKING: 18 SPACES PROVIDED PARKING: 18 SPACES (1 SPACE PER 300 S.F.)
<b>BUILDING 2</b> MEDICAL OFFICE BUILDING 7,500 SF	REQUIRED PARKING: 25 SPACES PROVIDED PARKING: 25 SPACES (1 SPACE PER 300 S.F.)
<b>BUILDING 3</b> PROFESSIONAL OFFICE BUILDING 5,600 SF	REQUIRED PARKING: 14 SPACES PROVIDED PARKING: 14 SPACES (1 SPACE PER 400 S.F.)
<b>TOTAL SF</b>	18,500 SF PROVIDED

ROWLETT  
CREEK  
WAY

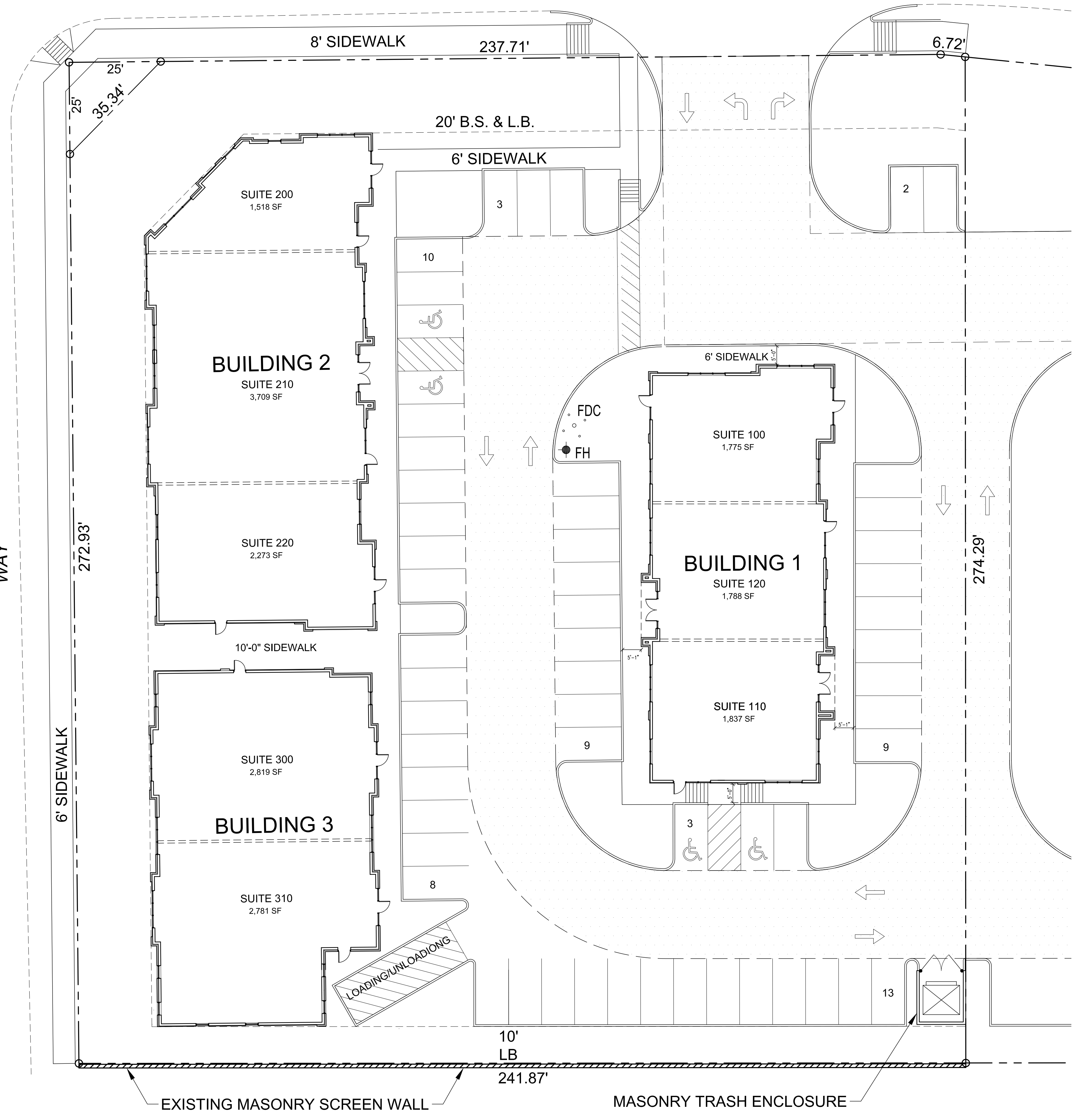

**CLOCK TOWER AT STACY**  
 SWC OF STACY & ALMA  
 MCKINNEY, TEXAS 75070

OWNER  
 STRUCTURAL ENGINEER  
 MEP ENGINEER

© COPYRIGHT 2018

INTERIM REVIEW DOCUMENTS  
 This document is preliminary and is not intended for  
 Regulatory Approval, Permit, or Construction  
 Purpose.  
 This document is issued under the authority of Gary  
 McCalla, 12519 on 04-18-19.

Revisions:

Issue Date:  
 Project No:  
 Sheet Title:  
 CONCEPTUAL  
 MASTER PLAN

Sheet No:  
**A1.01**